

Pressed steel flange bearing units (zinc plated housings)

ASPFL2

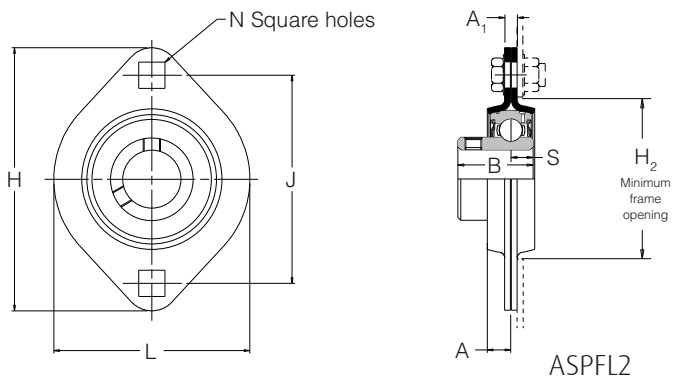

Unit number	Dimensions (mm)									
	Shaft diameter	L	H	H ₂	J	N	A	A ₁	B	S
ASPFL201	12	58.7	81.0	49.0	63.5	7.1	6.7	4.0	22	6.0
ASPFL202	15	58.7	81.0	49.0	63.5	7.1	6.7	4.0	22	6.0
ASPFL203	17	58.7	81.0	49.0	63.5	7.1	6.7	4.0	22	6.0
ASPFL204	20	66.7	90.5	55.0	71.5	8.7	7.7	4.0	25	7.0
ASPFL205	25	71.0	95.3	60.0	76.0	8.7	8.7	4.0	27	7.5
ASPFL206	30	84.1	112.7	71.0	90.5	10.5	9.0	5.0	30	8.0
ASPFL207	35	93.6	122.6	81.0	100.0	10.5	10.0	5.0	32	8.5

Bearing number	Housing number	Max. radial housing load N	Rec. max. speed min ⁻¹	Mass (approx.) kg
AS201	PFL203	2670	3000	0.2
AS202	PFL203	2670	3000	0.2
AS203	PFL203	2670	3000	0.2
AS204	PFL204	3110	3000	0.3
AS205	PFL205	3560	2500	0.3
AS206	PFL206	4890	2500	0.5
AS207	PFL207	6250	2000	0.7

Pressed steel flange bearing units (zinc plated housings)

AELPFL2

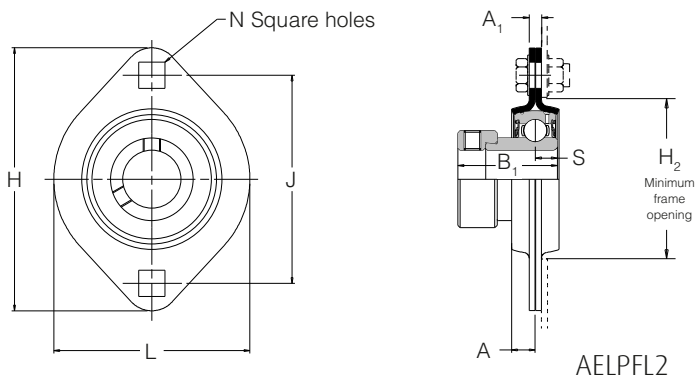

Unit number	Dimensions (mm)									
	Shaft diameter	L	H	H ₂	J	N	A	A ₁	B ₁	S
AELPFL201	12	58.7	81.0	49.0	63.5	7.1	6.7	4.0	28.6	6.5
AELPFL202	15	58.7	81.0	49.0	63.5	7.1	6.7	4.0	28.6	6.5
AELPFL203	17	58.7	81.0	49.0	63.5	7.1	6.7	4.0	28.6	6.5
AELPFL204	20	66.7	90.5	55.0	71.5	8.7	7.7	4.0	31.0	7.5
AELPFL205	25	71.0	95.3	60.0	76.0	8.7	8.7	4.0	31	7.5
AELPFL206	30	84.1	112.7	71.0	90.5	10.5	9.0	5.0	35.7	9.0
AELPFL207	35	93.6	122.6	81.0	100.0	10.5	10.0	5.0	38.9	9.5

Bearing number	Housing number	Max. radial housing load N	Rec. max. speed min ⁻¹	Mass (approx.) kg
AEL201	PFL203	2670	3000	0.2
AEL202	PFL203	2670	3000	0.2
AEL203	PFL203	2670	3000	0.2
AEL204	PFL204	3110	3000	0.3
AEL205	PFL205	3560	2500	0.3
AEL206	PFL206	4890	2500	0.5
AEL207	PFL207	6250	2000	0.7