



PNEUMATIC COUPLINGS
PNEUMATISCHE KUPPLUNGEN

SERIE 027E

DN 10



Materials

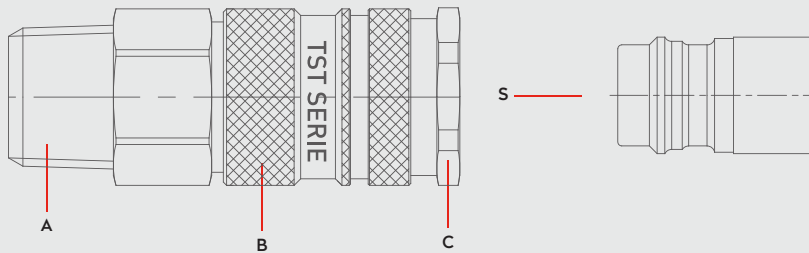

Material Code

A = Brass Nickel Plated

B = Brass Nickel Plated

C = Brass Nickel Plated

S = Steel Nickel Plated



0 - 12 bar
(0-174 PSI)



-20° to +100°C (NBR)
-4° to +212°F

Shut Off
Type

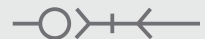

OM 178 - 01280
OM 260 - 00835
OM 157 - 01700
O27 EVC 00M

SAFETY LOCK

DN

10 mm

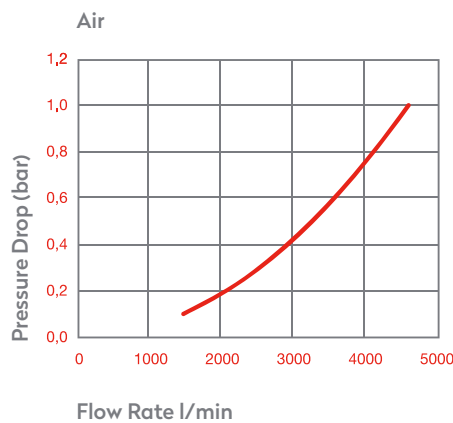

Options

AISI316
Stainless Steel

Plug Profile Serie 027E

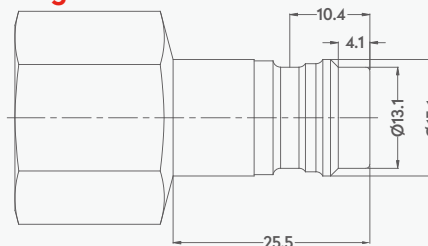

Compatible with

CEJN

442, 443



QUICK COUPLINGS SCHNELLKUPPLUNGEN

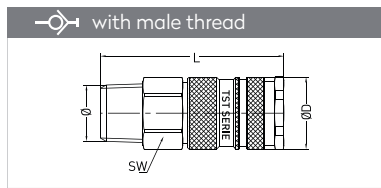

Connection	Part No.	SW	L	ØD
BSPT 1/4"	027 RGE 13	25	67,5	28
BSPT 3/8"	027 RGE 17	25	67,5	28
BSPT 1/2"	027 RGE 21	25	71,5	28
BSPT 3/4"	027 RGE 26	27	65,5	28
NPT 3/8"	027 TGE 17	25	68,5	28
NPT 1/2"	027 TGE 21	25	72,5	28
NPT 3/4"	027 TGE 26	27	66,5	28

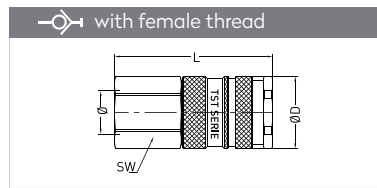

Connection	Part No.	SW	L	ØD
BSP 1/4"	027 DGE 13	25	61,5	28
BSP 3/8"	027 DGE 17	25	61,5	28
BSP 1/2"	027 DGE 21	25	61,5	28
BSP 3/4"	027 DGE 26	30	68,5	28
NPT 3/8"	027 NGE 17	25	63,5	28
NPT 1/2"	027 NGE 21	25	63,5	28
NPT 3/4"	027 NGE 26	30	70,5	28

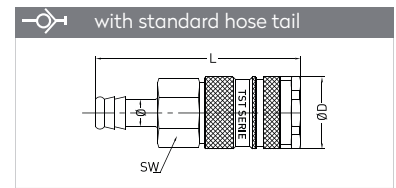

Connection	Part No.	SW	L	ØD
6 mm - 1/4"	027 HGE 06	25	76,5	28
8 mm - 5/16"	027 HGE 08	25	76,5	28
9 mm - 5/14"	027 HGE 09	25	76,5	28
10 mm - 3/8"	027 HGE 10	25	76,5	28
13 mm - 1/2"	027 HGE 13	25	76,5	28
16 mm - 5/8"	027 HGE 16	25	76,5	28
19 mm - 3/4"	027 HGE 19	25	76,5	28

PLUGS STECKNIPPEL

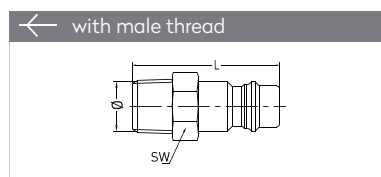

Connection	Part No.	SW	L
BSPT 1/4"	027 RUE 13	17	45,5
BSPT 3/8"	027 RUE 17	17	46,5
BSPT 1/2"	027 RUE 21	22	52
BSPT 3/4"	027 RUE 26	27	53,5
NPT 3/8"	027 TUE 17	17	47,5
NPT 1/2"	027 TUE 21	22	53
NPT 3/4"	027 TUE 26	27	54,5

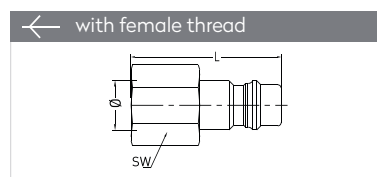

Connection	Part No.	SW	L
BSPT 1/4"	027 DUE 13	17	40
BSPT 3/8"	027 DUE 17	19	40
BSPT 1/2"	027 DUE 21	24	46
BSPT 3/4"	027 DUE 26	32	46
NPT 3/8"	027 NUE 17	19	42
NPT 1/2"	027 NUE 21	24	48
NPT 3/4"	027 NUE 26	30	48

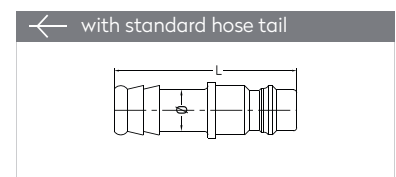

Connection	Part No.	L	ØD
6 mm - 1/4"	027 HUE 06	52	16
8 mm - 5/16"	027 HUE 08	52	16
9 mm - 5/14"	027 HUE 09	52	16
10 mm - 3/8"	027 HUE 10	52	16
13 mm - 1/2"	027 HUE 13	52	16
16 mm - 5/8"	027 HUE 16	52	18
19 mm - 3/4"	027 HUE 19	52	21