



PNEUMATIC COUPLINGS
PNEUMATISCHE KUPPLUNGEN

SERIE 111

DN10



Materials

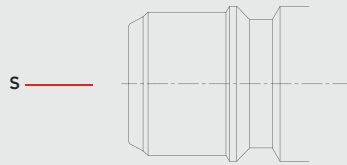
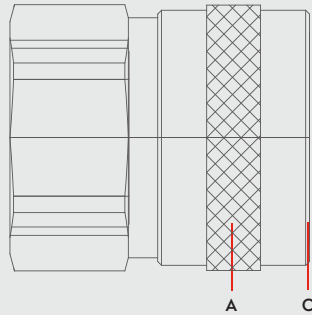

Material Code

A = Brass Chrome Plated

C = Brass Chrome Plated

S = Steel Zinc Plated



0 - 35 bar
(0 - 507 PSI)



-20° to + 200°C (NBR)
-4° to + 392°F

Shut Off Type



OV 262 - 01785
OV 262 - 02025

FLOW

120 lt/min

DN

10 mm

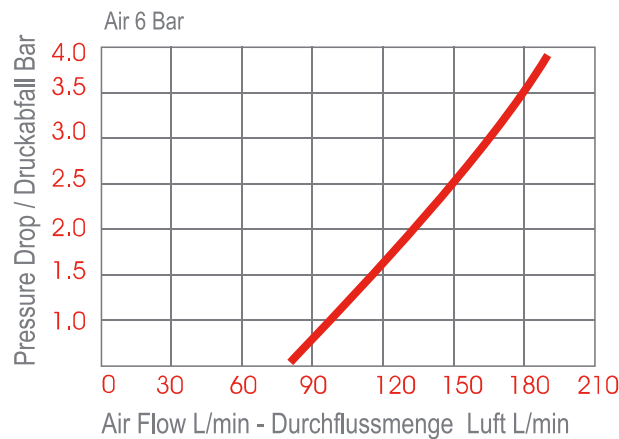

Options

FPM

EPDM

NICKEL

AISI316

Stainless Steel

AISI303

Stainless Steel



Plug Profile Serie 111

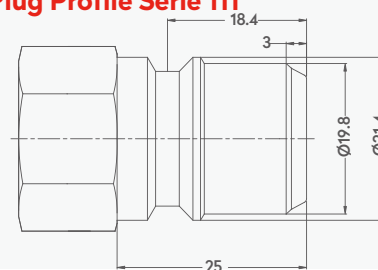

Compatible with

TEMA 3800
NITO 6550



QUICK COUPLINGS SCHNELLKUPPLUNGEN

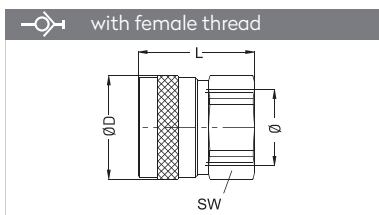

Connection	Part No.	SW	L	ØD
BSP 3/8"	111 DGF 17	30	39	34

PLUGS STECKNIPPEL

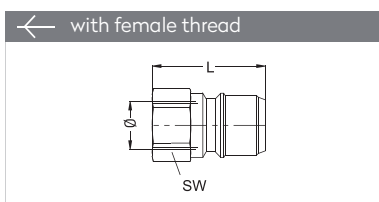

Connection	Part No.	SW	L
BSP 3/8"	111 DU 17	22	38